

Tiltrotator EC209

engcon®

Suitable for all excavators in the 6-9 tonne weight class

A compact, powerful tiltrotator with low weight for excavators up to 9 tons. If the EC209 is selected with engcon's standard quick hitch S45 and the proportional control system DC2, EC-Oil is offered an automatic quick hitch system as a free standard**. This means that the tiltrotator and hydraulic tools can be connected & disconnected without the operator needing to leave the cab.

Comes supplied with hose, quick couplings and electrical installation equipment for one machine.

Advantages:

- » The EC-Oil automatic quick hitch system connects the tiltrotator & hydraulic tools without the operator needing to leave the cab**
- » Q-Safe quick hitch for maximum safety
- » Comes ready for detachable gripper GRD (S45)
- » Comes ready for sweeper SWD (S45)
- » Comes ready for the QSC locking system to avoid wrongly connected or dropped buckets
- » Comes ready for a rotation sensor (ePS) for connection to the excavator guidance system
- » Central lubrication (a single grease point for the entire tiltrotator; can also be connected to the excavator's central lubrication system)
- » Load-holding valves on tilt cylinders for maximum safety
- » Hardened piston rods
- » Up to $\pm 45^\circ$ tilt angle for best access
- » Rotation ∞

Quick hitch: Standard –S45. For other purposes, we can supply most types of hitches available on the market.

Control system: Standard – DC2 proportional control system for infinitely variable control with remote support capability, track/wheel steering and boom slew. For other purposes, we can deliver custom control systems.

Electrical system: Can be adapted for 12 or 24 volt electrical systems.

Accessory: GRD detachable gripper cassette*, SWD detachable sweeper*.

* Read more about the GRD at www.engcon.com

** Read more about the terms and conditions concerning the EC-Oil automatic quick hitch system as a free standard at www.engcon.com



Specifications

| Type | EC209 |
|---|----------|
| Width A: (mm)* | 277 |
| Width B: (mm)* | 250 |
| Width C: (mm)* | 273 |
| Length overall D: (mm)* | 561 |
| Construction height E: (mm)* | from 425 |
| Weight: (kg)* | 287 |
| Tilt: | 2x45° |
| Rec. hydraulic flow DC2/SS10 (l/min): | 60 |
| Rec. hydraulic flow SS9 tilt/rotation: (l/min): | 35/40 |
| Max hydraulic pressure: (MPa) | 22 |
| Standard attachments: | S45, S50 |
| Max bucket width rec. by Engcon: (mm) | 1,300 |
| Max breakout torque: (kNm) | 74 |
| Base machine weight: (t) | 6–9 |

*Standard attachment

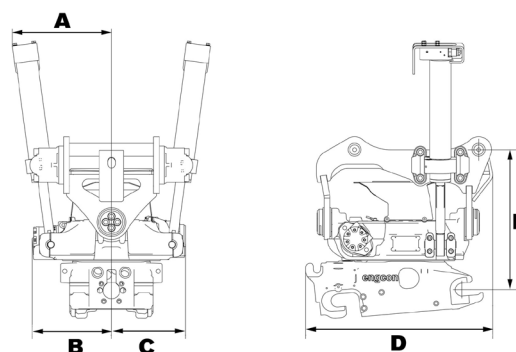

TOOL SYSTEMS FOR INCREASED PROFITABILITY

engcon UK Ltd. 200B Ashchurch Business Centre, Tewkesbury, GL20 8TD | Phone +44 (0)1684 297 168

E-mail uk@engcon.com | Web www.engcon.com